

The History of Race and Housing in Arlington

The Alliance for Housing Solutions

National Archives



AHS is a 501(c)(3) nonprofit organization working to increase the supply of affordable housing in Arlington County and Northern Virginia through public education, policy development, advocacy and innovation.



Arlington *for* **Everyone**™

The Alliance for
Housing Solutions

Tonight's Agenda

- **Presentation: Dr. Lindsey Bestebreurtje**
- **Historical Highlights and Personal Reflections**
 - Scott Taylor
 - Dr. Alfred Taylor, Jr.
 - Wilma Jones
 - Craig Syphax
 - Sandra Green
 - Kitty Clark Stevenson
- **Discussion and Q&A with the Audience**
 - Kathleen McSweeney (moderator)

Race & Housing
in Arlington

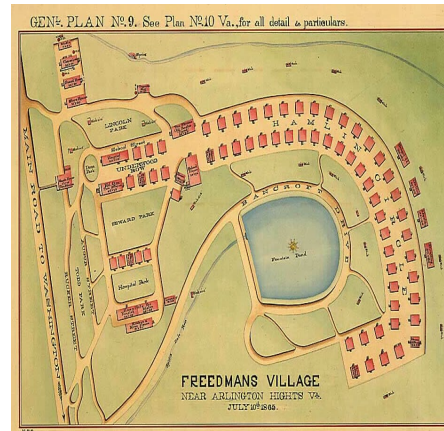
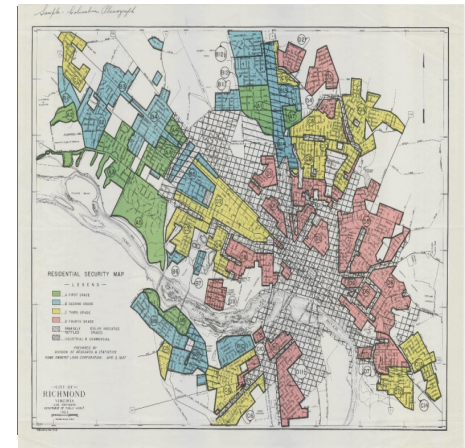

“The Fastest Growing County in America”: Suburbanization, Segregation, and Community Development in Arlington County, Virginia

Dr. Lindsey Bestebreurtje

+ Background

■ Arlington at a Glance

- 1790 – gifted by Virginia for the District
- 1846 – retroceded back to Virginia
- 1920 – name change to “Arlington County” from “Alexandria County”

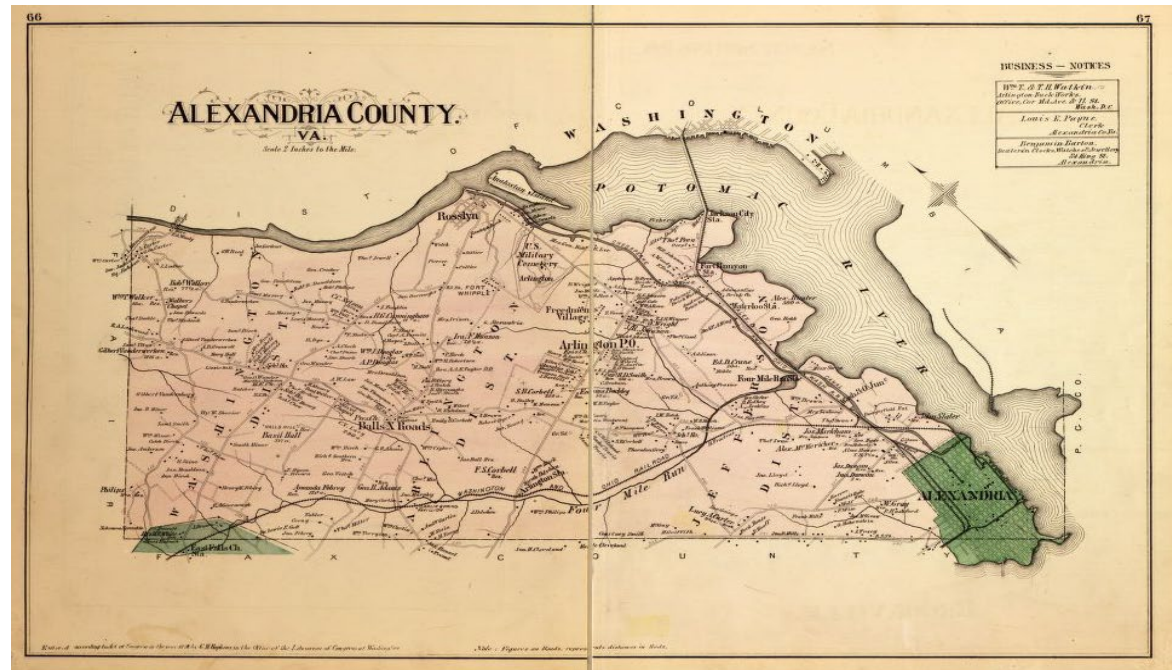

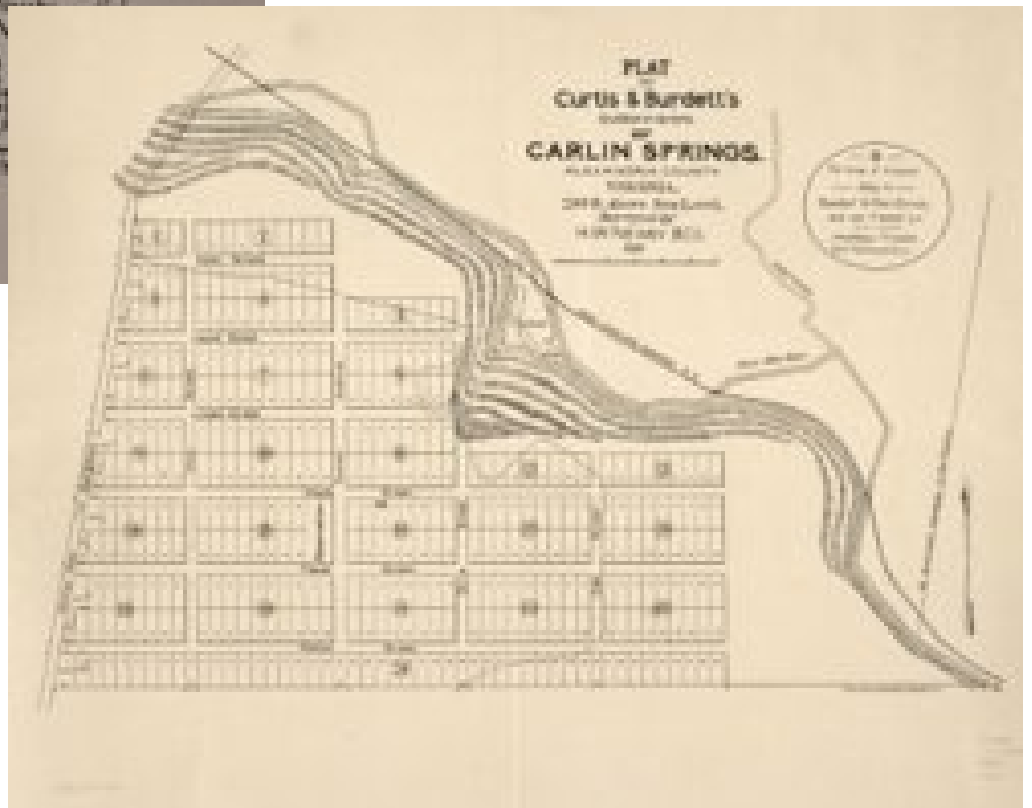

Railroad and Neighborhood Expansion

+ County Growth



Arlington's Black Communities

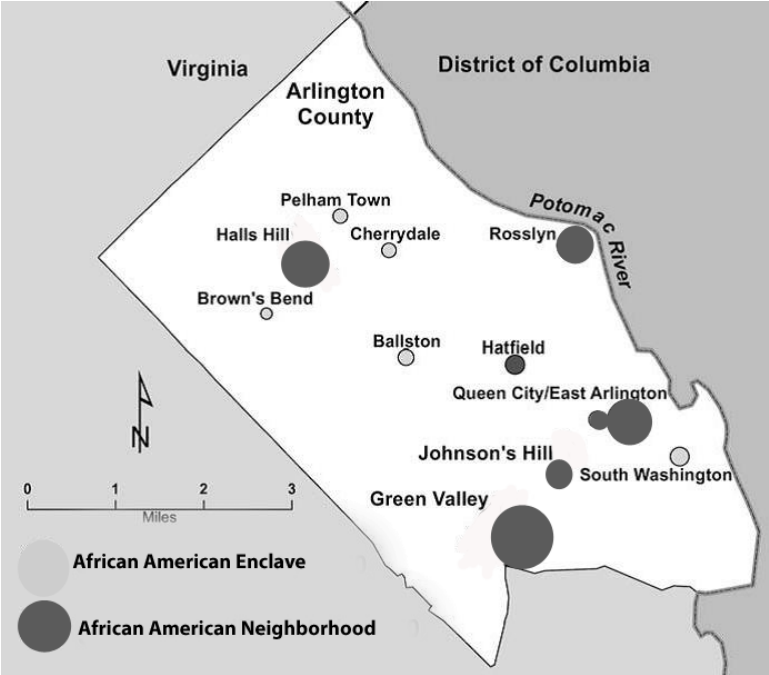

Arlington at a Glance



+ Frank Lyon, Lyon Village, & Lyon Park



LYON VILLAGE

Midway between the business section of Washington and the Washington Golf and Country Club via the Arlington Memorial Bridge: a ten-minute drive through Federal Parks and Reservations over Washington's Finest Boulevard Approaches.

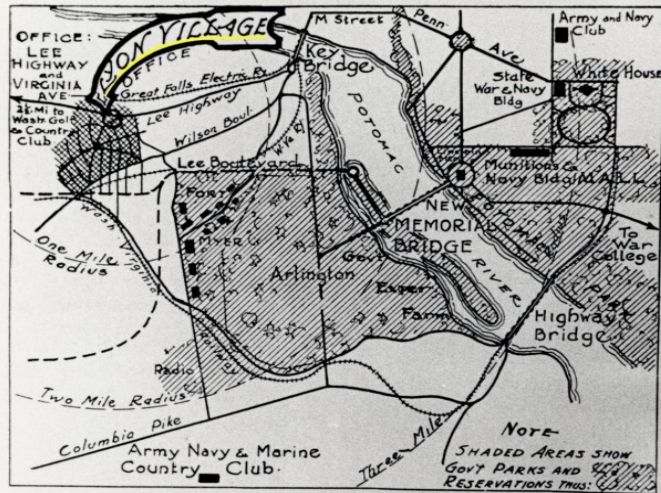

A glance at the map shows you how conveniently important points may be reached over the new Memorial Bridge or the Key Bridge, but it cannot give you any idea of the **ALTITUDE, BEAUTY** and **PICTURESQUENESS** of

LYON VILLAGE

Here, in Washington's finest close-in suburb, are ideal homes. In the midst of native trees and rippling streams, beautiful parks are being provided, fully equipped for the amusement of children. Close proximity to downtown Washington insures the owners of an ever-increasing property value. Bus lines and electric cars denote extreme accessibility.

Drive out and see how quick the approach, and how attractive these homes in charming "Old Virginia"

FOR INSPECTION CALL

LYON & FITCH, INC.

Main 4198





"Clean Up" of Rosslyn

Lyon, Mackey, and The Good Citizen's League

County Growth

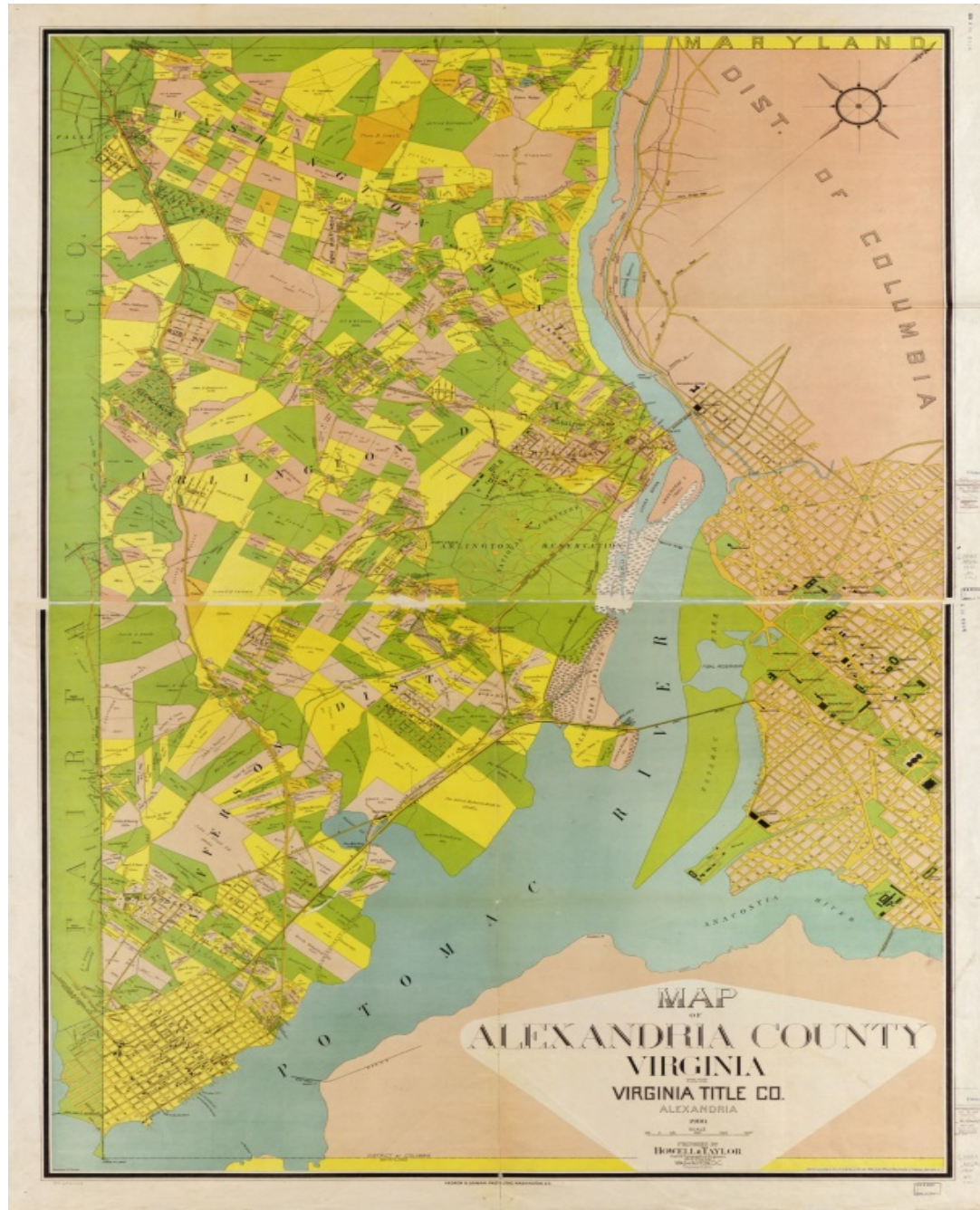

+ Definitions



- Covenants
 - Legally enforceable “contract” imposed in a deed upon all future buyers of a property.

- Restrictive Covenants
 - Contractual agreements that prohibit the purchase, lease, or occupation of a piece of property by a particular group of people, usually African Americans.
 - Used by individual sellers, real estate boards, and neighborhood associations

- Suburban
 - Defined by historian Kenneth Jackson via “function (non-farm residential), class (middle and upper status), separation (a daily journey to work), and density (low relative to older sections).”

+ Challenging the "Suburban Ideal"



The Arlington Courier
Northern Virginia's Largest Newspaper

Vol. III—No. 17 Entered as second-class matter at Arlington, Virginia. Arlington, Va., Thursday, August 11, 1938 Published Every Thursday in Arlington County, Virginia. Price 5c Per Copy

ROW HOUSES CONDEMNED

CIVIC FEDERATION MASS MEETING DEMANDS THAT THEY BE STOPPED

Colonel Garnett's Broadside Is Applauded By Monarchs, Lions, Rotarians, Kiwanians

+ Segregation & Racism in Arlington

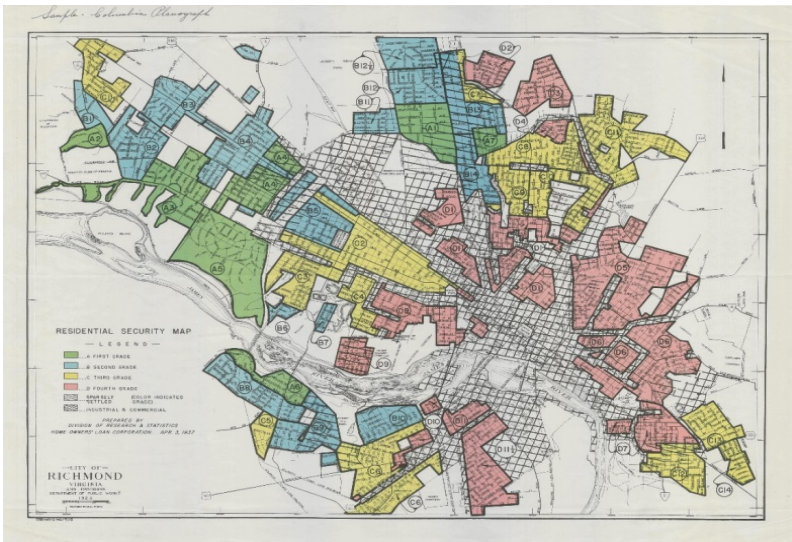



Arlington's Suburban Boom



GREATEST U. S. BOOM TOWN IS THE NATION'S CAPITAL

is now bringing workers to Washington at a rate of 350 a week. The city has not yet come to the point of building barracks for clerks beside the Union Station as it did in War I days, but it may soon.

Washington's growth is not merely a defense phenomenon. Defense has only given an extra filip to something which has been going on steadily since the first days of the New Deal. In 1933, for instance, Washington had 271 beauty parlors doing a business of \$1,500,000 a year. In 1940 it had 690 beauty parlors turning over \$3,300,000 a year. When the 1940 census was taken last spring, Washington showed by far the greatest growth of any major U. S. city, having jumped since 1930 from 14th to eleventh largest with an increase of 176,284 (36.2%) to a population of 663,153. Since the census began eleven months ago, an estimated 65,000 people have migrated to live in Washington, and it has almost certainly passed Pittsburgh to become the tenth city of the land.

Today Washington stands as visible evidence of the peaceful revolution which has been going on in American life since 1933. This social and economic revolt is, by general agreement, permanent. Even if Willkie had been elected last year, the Federal Government would unquestionably have gone on being far bigger and playing a far bigger part in U. S. lives than ever before. Today the citizen who goes to Washington sees the future in action.

CONTINUED ON NEXT PAGE



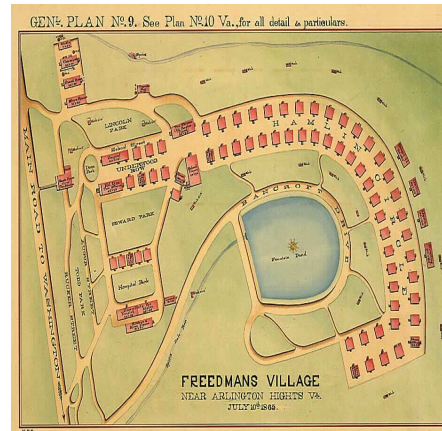
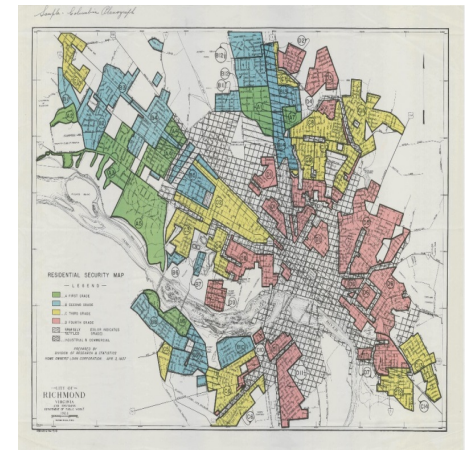

Thank you!

Dr. Lindsey Bestebreurtje

Curatorial Assistant at the Smithsonian's
National Museum of African American
History and Culture

bestebreurtjeml@si.edu

Tonight's Agenda

- **Presentation: Dr. Lindsey Bestebreurtje**
- **Historical Highlights and Personal Reflections**
 - Scott Taylor
 - Dr. Alfred Taylor, Jr.
 - Wilma Jones
 - Craig Syphax
 - Sandra Green
 - Kitty Clark Stevenson
- **Discussion and Q&A with the Audience**
 - Kathleen McSweeney (moderator)

built by the people themselves

[browse items](#) [browse collections](#) [browse exhibits](#) [about](#) [map](#) [contact us](#)

A Digital Exploration of Community Building in Arlington County, Virginia

"Built by the People Themselves" explores the processes of community development and suburbanization in Arlington County, Virginia. Arlington is a small county located in northern Virginia, just across the Potomac River from Washington, D.C.

This site is a piece of my doctoral dissertation from George Mason University. Since its earliest suburban development, Arlington was made up of diverse neighborhoods, each with divergent, competing visions for the area's future. My exploration of the process of creating and defending communities within the suburban environment will analyze how the physical environment of Arlington reflected racial tensions, as competitions over race, space, and aesthetics literally built a physical manifestation of a county divided under Jim Crow. This study tracks the roles of the government, community institutions, and planning.

